



# Enviro400ER

## ELECTRIC RANGE HYBRID BUS

The Alexander Dennis Enviro400ER offers geofenced Electric Range zero-emission capability, making it an ideal solution for pollution hotspots in towns and cities. Based on proven BAE Systems series hybrid technology, the Enviro400ER provides an easy solution to meet local zero-emission zones without an impact on daily operational range. The Enviro400ER is available with a wide range of specification options including the eye-catching City style body with its glazed staircase.





## Features and benefits

- AD24 whole-vehicle aftermarket support
- Low Emission Bus certification
- Proven BAE Systems hybrid technology
- Runs up to three miles in zero-emission mode, subject to route profile
- Optional plug-in battery charging
- Available with the eye-catching City body with glazed staircase and wrap-over rear window



## Technical specifications

<b>Dimensions</b>	11.0m length / 5.8m wheelbase / 2.55m width / 4.3m height
<b>Passenger capacity</b>	Up to 67 seats
<b>Accessibility</b>	1 wheelchair space accessed via powered ramp at front door or manual ramp at centre door
<b>Heating and ventilation</b>	Blown-air heating system with forced air ventilation, option of air chill
<b>Hybrid system</b>	BAE Systems Series-ER diesel-electric extended range series hybrid system
<b>Diesel engine</b>	Cummins B4.5 (4 cylinder, 4.5 litre, 157kW (210PS), Euro VI)
<b>Electric motor</b>	BAE Systems DDTM100 permanent magnet motor (195kW peak power, 2100Nm peak torque)
<b>Energy storage system</b>	32kWh NMC battery
<b>Battery charging</b>	Self-charging, option of external socket for DC plug charging
<b>Front axle</b>	Dana NDS80LF, drop centre, 55° lock angle
<b>Drive axle</b>	ZF AV133, drop centre
<b>Tyres</b>	275/70R22.5

## Sample seating layout

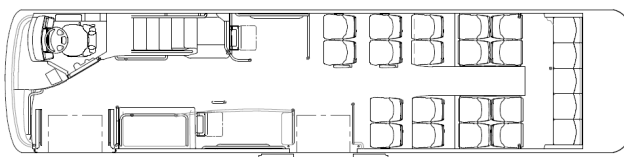

Lower deck with 23 fixed seats, 2 tip-up seats + 1 wheelchair space

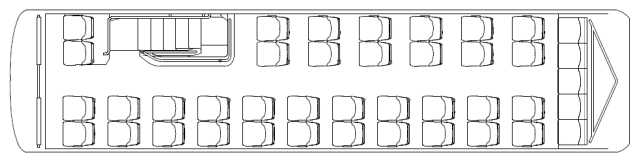

Upper deck with 41 seats