



# Enviro100EV

*THE BIG SMALL BUS*

The Alexander Dennis Enviro100EV is the battery-electric small bus for Transport for London routes that feels just like a big bus, engineered with the same care and attention to durability and detail as part of the next generation of Alexander Dennis zero-emission buses.

This reliable and efficient midibus meets TfL requirements for the capital's smallest single deck buses, including the latest advances of the capital's Bus Safety Standard.



## Features and benefits

- Designed and built by Alexander Dennis
- AD24 whole-vehicle aftermarket support
- 5-year standard vehicle warranty
- Up to 1.2GWh warrantable energy throughput
- 0.54kWh/km energy efficiency in UK Bus Cycle
- Up to 285 miles range on a single charge
- Up to 45 passengers total capacity
- TfL Bus Safety Standard compliant



## Technical specifications

<b>Construction</b>	Welded steel chassis and stainless steel body
<b>Dimensions</b>	8.5m length / 4.5m wheelbase / 2.35m width / 3.1m height
<b>Manoeuvrability</b>	8.6m turning radius
<b>Tyres</b>	245/70 R17.5
<b>Passenger capacity</b>	Up to 45 passengers with up to 21 seats
<b>Accessibility</b>	1 wheelchair space accessed via electric ramp at front door
<b>Electric motor</b>	Voith Electrical Drive System MD, 250kW peak and 230kW continuous power
<b>Battery system</b>	Impact NMC lithium-ion battery, 236kWh or 354kWh
<b>Charging system</b>	CCS2 DC plug charging at up to 118kW (236kWh battery) or 150kW (354kWh battery) nominal power with sockets mounted on either or both sides of the vehicle, optional roof-mounted rails for pantograph charging at up to 118kW (236kWh battery) or 177kW (354kWh battery)
<b>Operational range</b>	Up to 190 miles (236kWh battery) or 285 miles (354kWh battery) range on a single charge at beginning of life
<b>Climate system</b>	Zero-emission heat pump capable of heating and cooling

## Sample seating layout

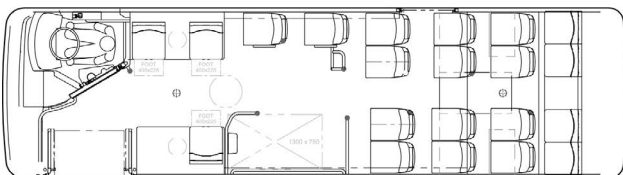

21 fixed seats + 1 wheelchair space